

**CERTIFIED LAND CORNER RECORDATION**

DESCRIPTION OF CORNER EVIDENCE FOUND, AND ORIGINAL RECORD (if known)

LOCATION  
 S. 7 | S. 8  
 S.18 | S.17  
 T.14N., R.61W.  
 6th P.M.

Found 8" x 8" x 16" white sandstone with 5 grooves and 4 grooves on adjacent faces. Stone was found floating (on top of ground).  
 G.L.O. record - Contract survey by J.W. Hammond in 1871 (Vol. 18) -  
 "Set Limestone 18 x 10 x 5 on top of ridge for corner . . ."

DESCRIPTION OF MONUMENT AND ACCESSORIES ESTABLISHED  
 TO PERPETUATE THE ORIGINAL LOCATION OF THIS CORNER:

Corner position accepted as point marked by old locust fence post bearing SE'ly, 4.3 feet distant from floating stone.  
 Set 1 1/2" dia. x 30" long iron pipe with brass cap for corner.  
 Left stone as memorial.

SKETCH, WITH COURSE AND DISTANCE TO ADJACENT CORNER IF DETERMINED IN THIS SURVEY.  
 (May Sketch or Paste Reproduction on Reverse Side.)

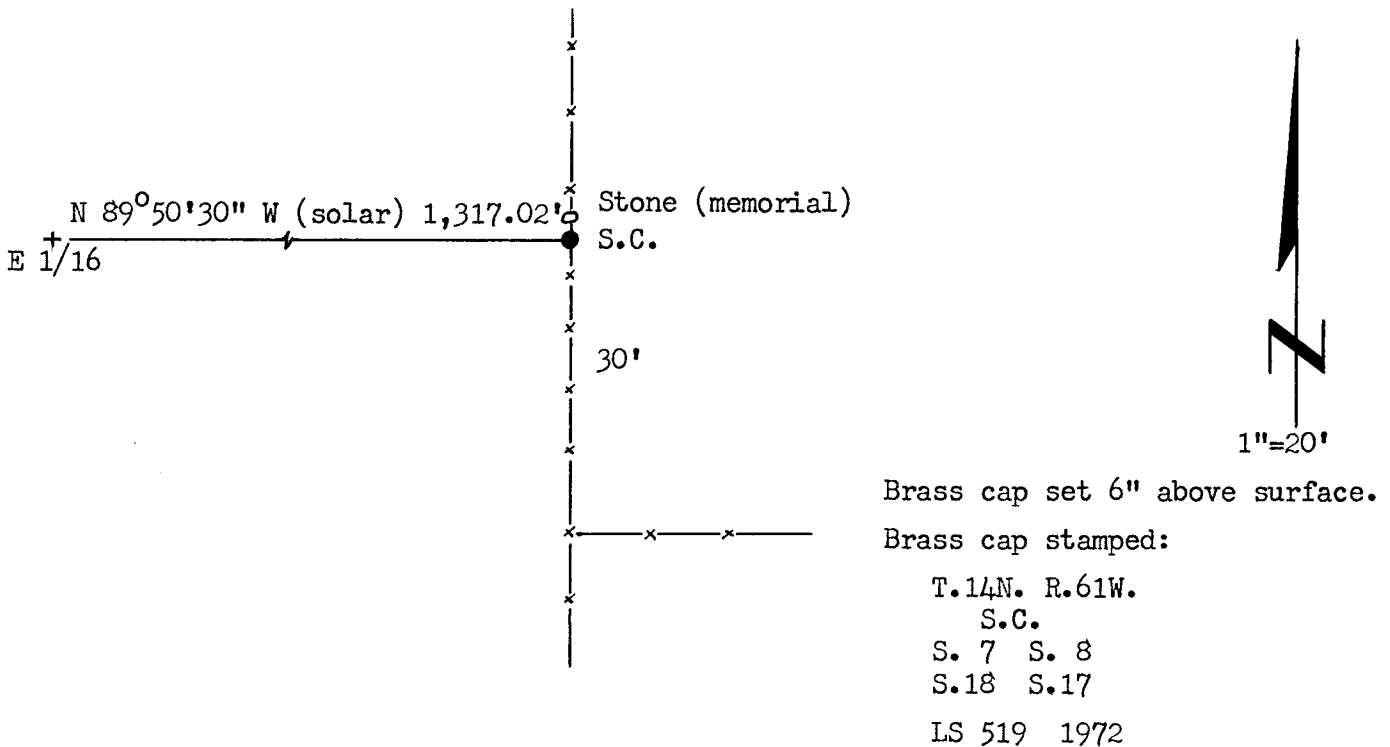

I, R.L. Hudson certify that I have carefully performed or reviewed the work done on the diagrammed corner as reported on this recordation form and approve the same.

R.L. Hudson Wyoming L.S. No. 519  
 Signature of Surveyor Registration No.

STATE OF WYOMING,  
 Office of Clerk and Recorder,  
 County of Laramie

This "corner record" was filed for record on the 12<sup>th</sup> day of June, 1972, was noted on the cross-index plat and is assigned page No. 14-61, in book No. ONE

Johy B. Hillman NW  
 County Official

Cross Index No. _____	T. _____	R. _____	Mer. _____
_____	T. _____	R. _____	Mer. _____
_____	T. _____	R. _____	Mer. _____
_____	T. _____	R. _____	Mer. _____
_____	T. _____	R. _____	Mer. _____
_____	T. _____	R. _____	Mer. _____
_____	T. _____	R. _____	Mer. _____

The State of Wyoming }  
County of Laramie } SS

This instrument was filed for record  
at 1:25 o'clock P. M. on the  
12th day of March  
A. D. 19 22 and duly recorded in  
Book ..... on page .....

*John B. Williams*

County Clerk & Ex-Officio Register of Deeds  
By \_\_\_\_\_, Deputy